

application guides

LOUNGE RECLINER BASICS	25
PLANNING WITH LOUNGE RECLINER	26
SOLO DESK BASICS	28
PLANNING WITH SOLO DESK	29
CONSULTATION HUB BASICS	30
PLANNING WITH CONSULTATION HUB	31
MEETING HUB BASICS	33
PLANNING WITH MEETING HUB	34
ACCESSORIES & STORAGE BASICS	36
PLANNING WITH ACCESSORIES & STORAGE	38
LOCKS GUIDE	39
FINISHES GUIDE	40

The Lounge Recliner is ideal for non-fixed address planning such as a retreat or a lounge area with minimal storage requirements.

Lounge Recliner (SWR)

- Suitable for 1 or 2 users
- Units are handed with the handedness being determined by the location of the storage monolith
- Storage monolith is 72" high and available with Coat/Shelf (A) and Coat/Drawer (C) internal configurations
- Doors are available as an option on all configurations
- Levelers are included with a 2" adjustment range
- Is standard with a Power Bar with one duplex receptacle and one blank data port

Finishes

Standard wire management grommet is finished in Platinum Grey. Cushions are available in Fabric or Leather. Please see *Finishes Guide* page in this section for Recliner finishes.

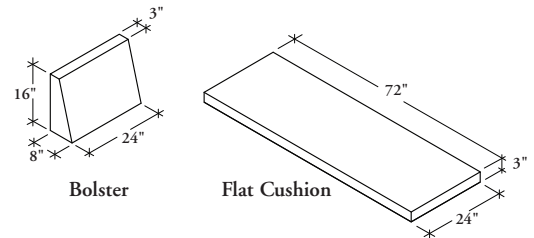

Lounge Recliner Upholstered Cushions (SWUC)

- Upholstered Cushion are available; Loose Bolster Only (LB), Fixed Flat Cushion Only (FC), Fixed Flat Cushion/Loose Bolster (FL) and Fixed Flat Cushion/Fixed Bolster (FF)
- Fixed Bolsters are screwed to the storage monolith through back of the Bolster
- Loose Bolsters are finished on all sides with zipper closure on bottom

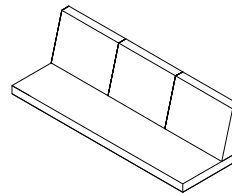
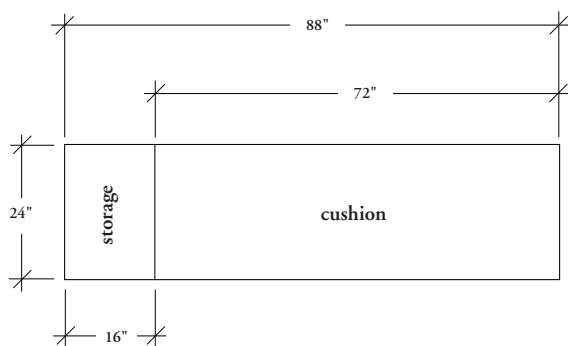

Loose Bolsters can be ordered separately to create different configurations along the recliner against a wall.

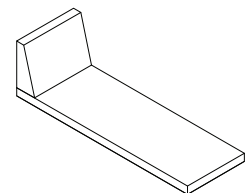

Bolster can be oriented vertically against storage monolith.

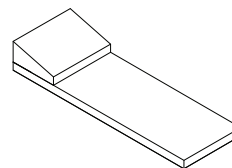

Loose Bolster can be placed in different orientations.

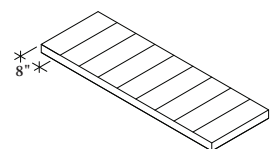

The leather option features an 8" striped stitch pattern.

application guides

planning with lounge recliner

The following should be considered when planning with Lounge Recliners.

planning considerations

26

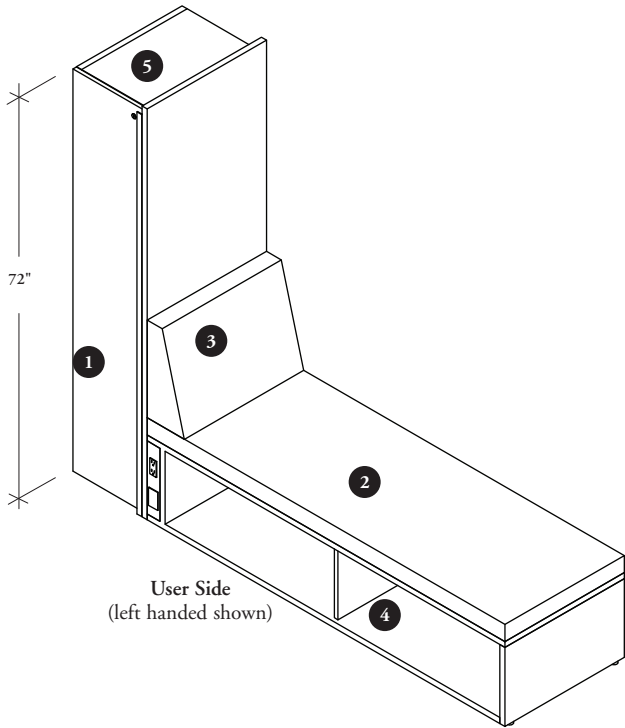

- 1 When optional hinged doors are specified, the location of the door hinge corresponds to the handedness of the unit. Locks are optional
- 2 Fixed Flat Cushions are ordered separately and must be ordered to complete the Recliner. If upholstered in Leather, there will be stitch pattern of nine 8" wide segments along the length of the cushion
- 3 Bolsters can either be loose or fixed. If specified loose they can also be repositioned along the length of the Recliner. If fixed, they will be secured in place. Additional Bolsters may be ordered separately
- 4 Open storage below is sized to fit carry-on luggage
- 5 Ambient Light (SWLED) and Pull-Out CPU Shelf (SWPS) may be ordered separately. For more information, please see the *Accessory Basics* page in this section

storage options

24" deep x 72" long x 16" deep (left hand version with optional door heights shown)

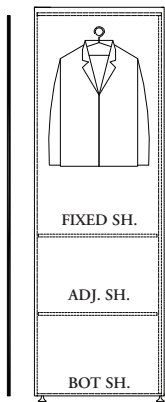

Coat/Shelf (A)

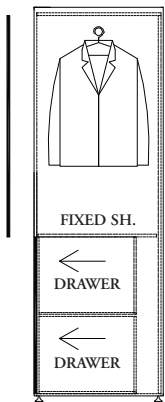

Coat/Drawer (C)

planning with lounge recliner (continued)

power bar

- The vertically integrated power and data receptacle is ideal for users to recharge mobile devices while working
- Power and communications is accessed through a Power Bar that is integrated under the bench at the storage opening for easy accessibility
- The Power Bar allows for one duplex receptacle and one blank data port and has a 10' cord and 90° plug
- A cut out on the bottom surface allows for wire management from the floor into the space behind the Power Bar
- Two grommets allow wire management from this space, one to the inside of the storage monolith for the LED Ambient Light (SWLED), and the other out to the Occupancy Sensor below the flat bench

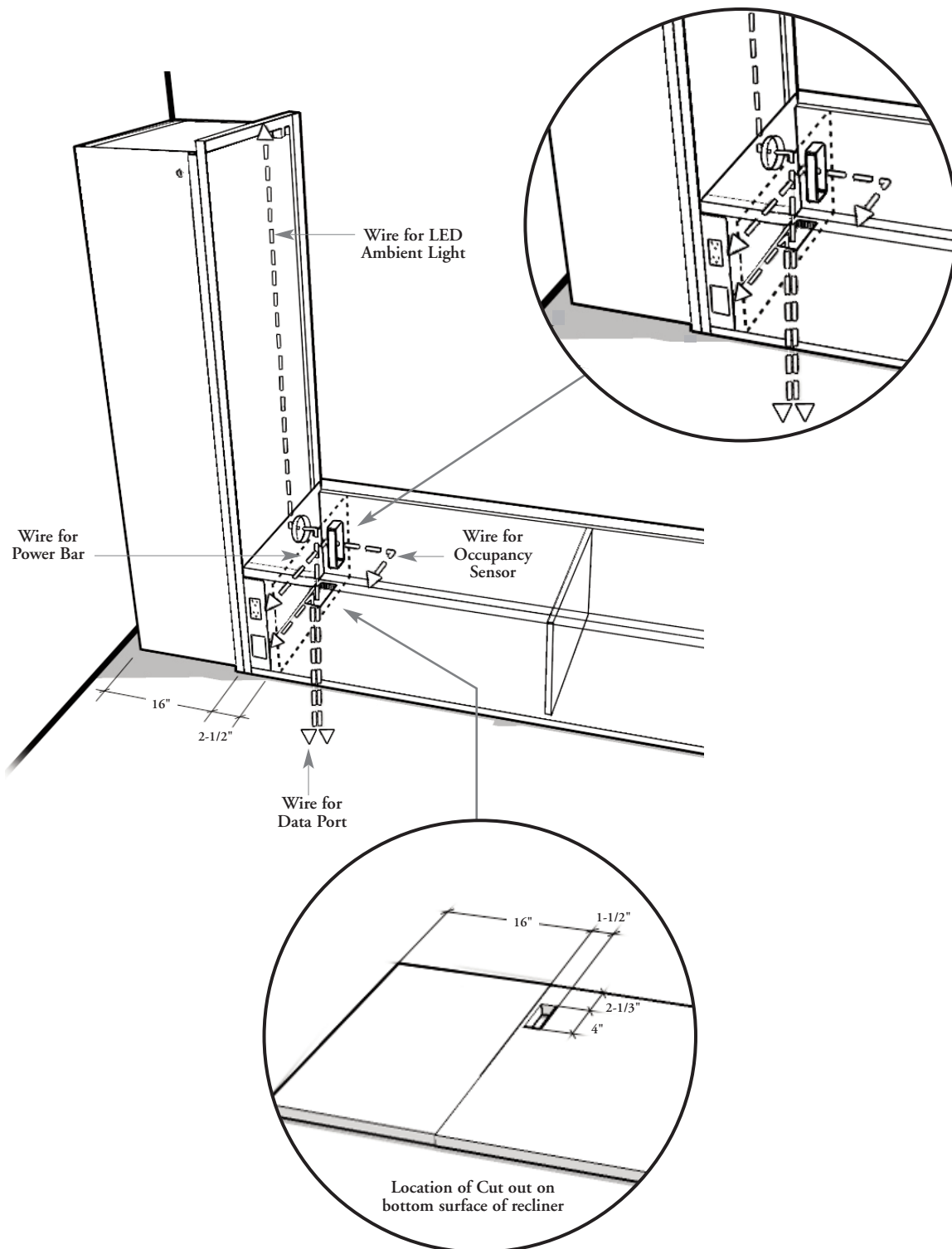

solo desk basics

The Solo Desk is a single user application, used in small private offices or enclaves and planned parallel to a wall in order to reduce the overall footprint.

28

Solo Desk (SWDS)

- Consists of a storage monolith, rectangular worksurface, rectangular leg and Technology Bridge
- Available with rectangular worksurface and rectangular leg only
- Worksurface available from 40" - 70" lengths, in 6" increments so when combined with the storage monolith provide widths of 66" - 90" and 24" and 30" depths
- Available in 29" desk height only
- Storage monolith available with Coat/Shelf (A), Shelf (B), Coat/Drawer (C), Shelf/Drawer (D), Multi-Drawer/Shelf (E) and Multi-Drawer/Drawers (F) configurations and match the depth of the worksurface
- Doors are available as an option on all configurations except the Multi-Drawer/Drawer (F) configurations
- Levelers are included with a 2" adjustment range in the bottom of the storage monolith and the rectangular leg support
- The storage monolith is not freestanding so cannot be used with other desks

Finishes

Standard wire management grommet is finished in Platinum Grey. Please see *Finishes Guide* page in this section for Desk finishes.

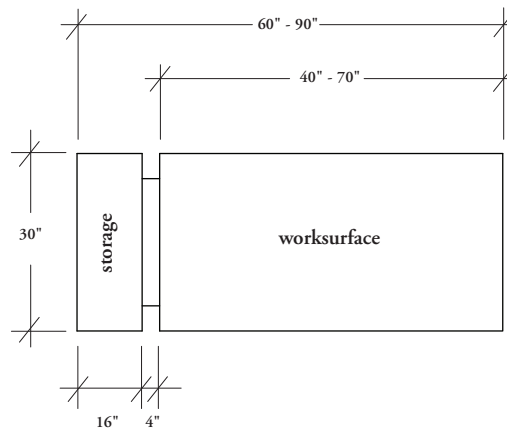
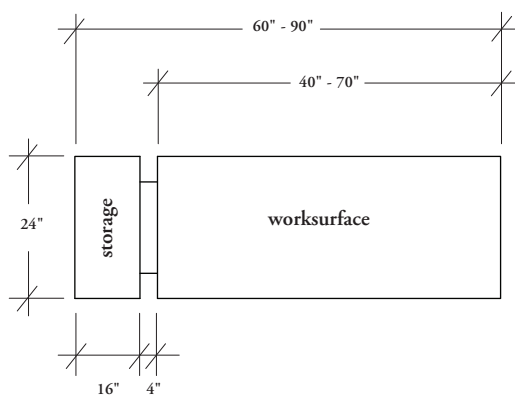
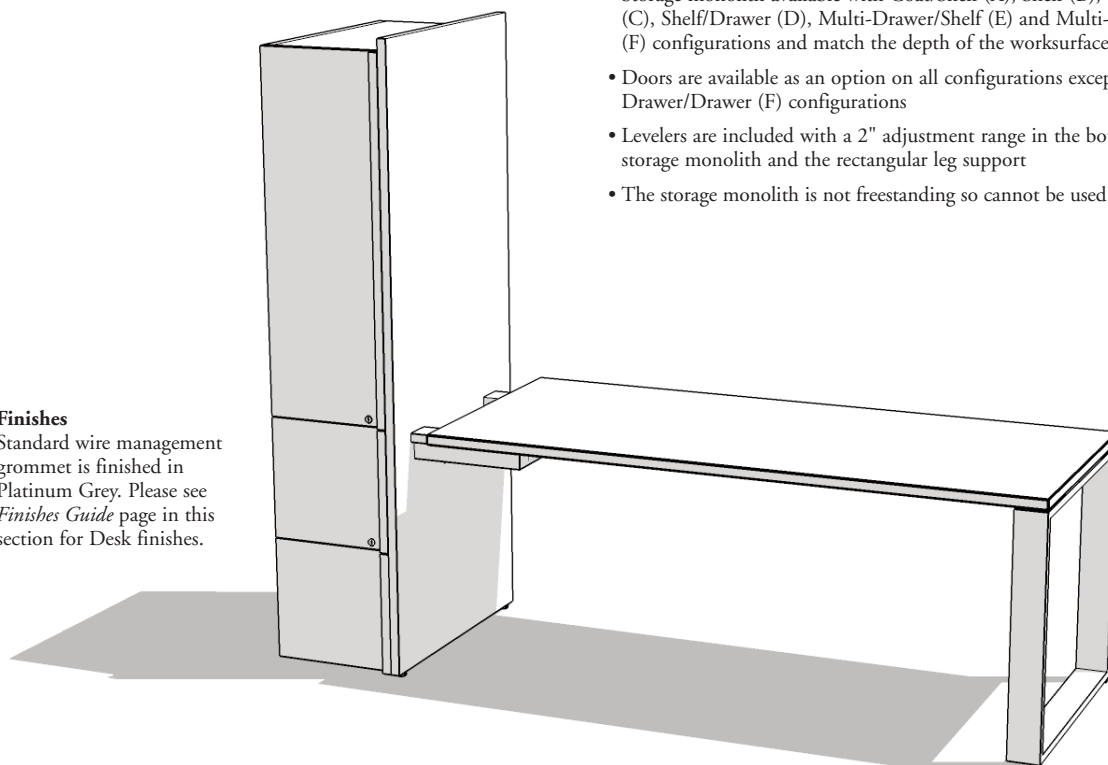

planning with solo desk

The following should be considered when planning with the Solo Desk.

planning considerations

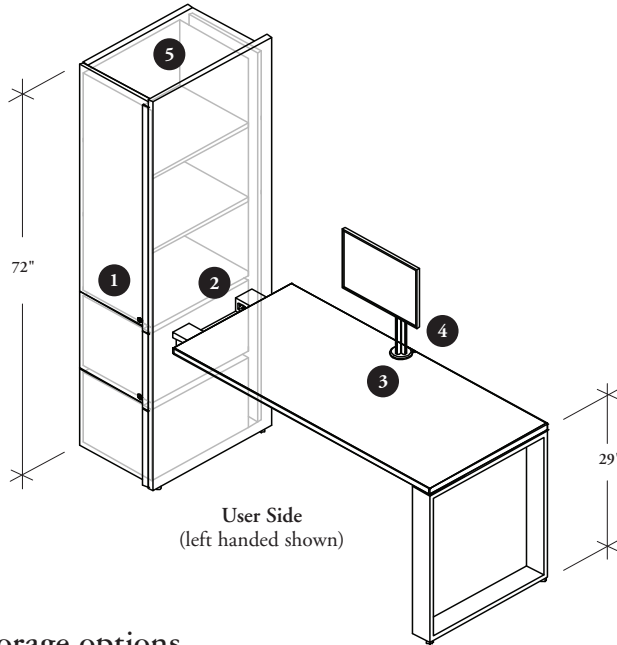

- 1 When optional hinged doors are specified the location of the door hinge corresponds to the handedness of the unit. Locks are optional. Available in 24" and 30" depths and 72" height only
- 2 The user side is determined by the location of power which always points to the user
- 3 Rectangular worksurfaces are available at desk height only
- 4 The MAST Arm can be ordered separately to support media based work and collaboration, and is available from Complements: *Teknion's Ergonomics & Accessories Program Catalog*. When using the MAST Arm with Sidewise it must be centered on a worksurface so that the user sits directly in front of the monitor
- 5 Ambient Light (SWLED), Modesty Panel (SWMP_), Pull-Out CPU Shelf (SWPS), and Accessory Rail Elements (SWDA) may be ordered separately. For more information, please see the *Accessory Basics* page in this section

storage options

24" deep x 72" high x 16" long (left hand version with optional door heights shown)

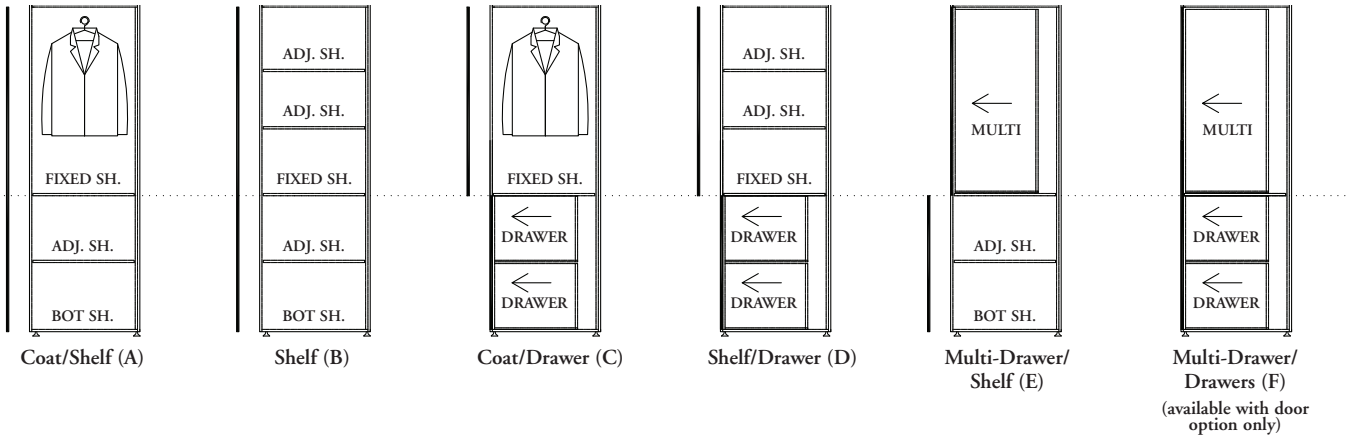

30" deep x 72" high x 16" long (left hand version with optional door heights shown)

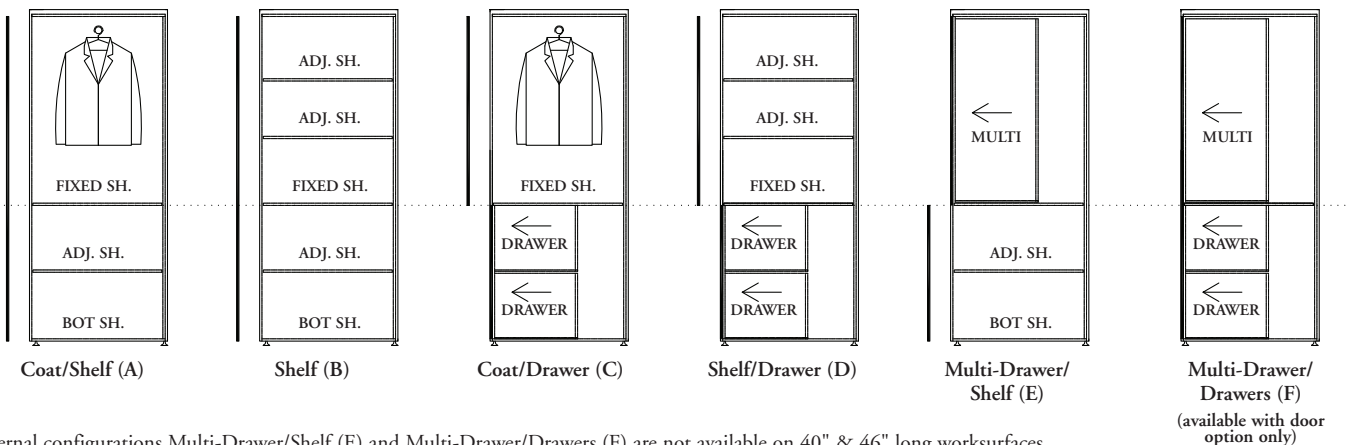

Internal configurations Multi-Drawer/Shelf (E) and Multi-Drawer/Drawers (F) are not available on 40" & 46" long worksurfaces

consultation hub basics

The Consultation Hub is ideal for fixed and non-fixed address planning in small private offices or enclaves and accommodates both transient users with little storage needs and resident users requiring compact workstation solutions.

Consultation Hub, 51" High Desk Height (SWER, SWEB), 72" High Desk Height (SWDR, SWDB), 72" High Counter Height (SWCR, SWCB)

- Accommodates up to three users (one user and two guests)
- Rectangular or bullet worksurface available from 40" - 70" lengths, in 6" increments so when combined with the storage monolith provide widths of 66" - 90" and 36" depth
- Available in two worksurfaces and leg styles, rectangular worksurface with rectangular leg or bullet worksurface with post leg
- Available in 29" & 36" work heights
- Configuration options for storage monolith available in 51" and 72" heights
- Configurations available in 51" high storage monolith: Shelves (B), with open shelves on guest side
- Configurations available in 72" high storage monolith: Coat/Shelf (A), Shelf (B), Multi-Drawer/Shelf (E) and Multi-Drawer/Drawers (F)
- Doors are available as an option on all configurations except the Multi-Drawer/Drawer configurations
- The storage monolith is not freestanding so cannot be used with other desks
- Levelers are included with a 2" adjustment range in the bottom of the storage monolith and both rectangular and post leg supports

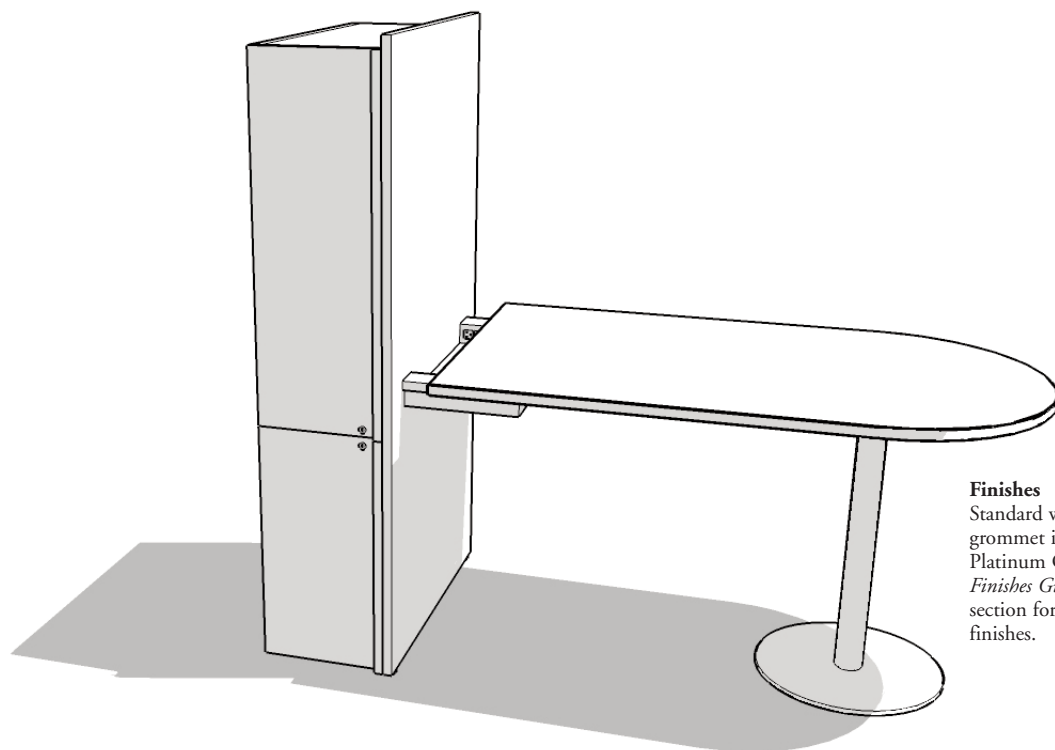

Finishes

Standard wire management grommet is finished in Platinum Grey. Please see *Finishes Guide* page in this section for Consultation Hub finishes.

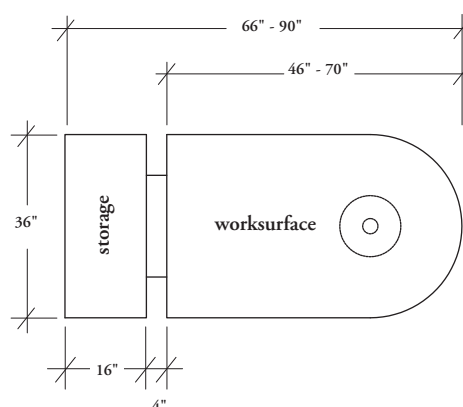
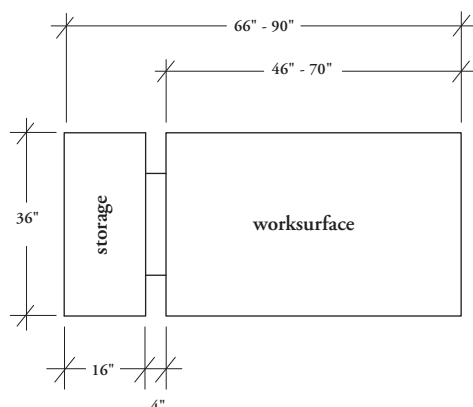

planning with consultation hub

The following should be considered when planning with the Consultation Hub.

height options

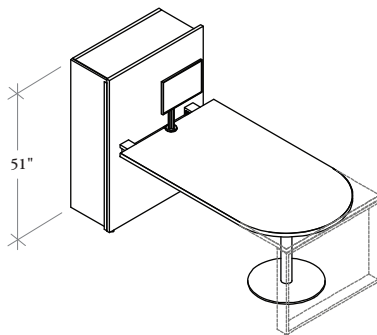

29" Desk Height
with 51" high
Storage Monolith

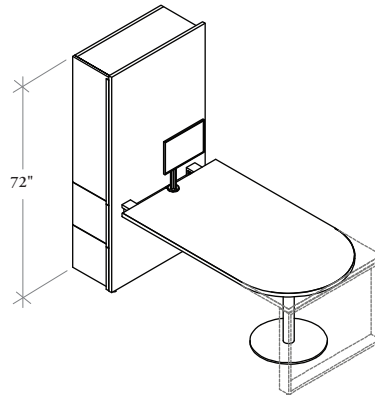

29" Desk Height
with 72" high
Storage Monolith

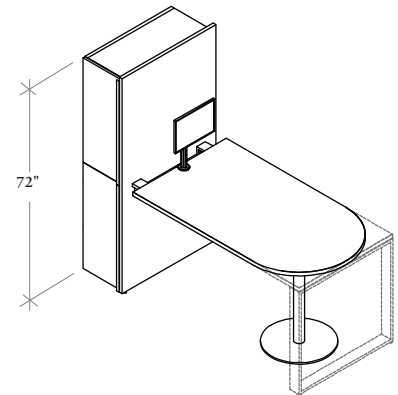

36" Counter Height
with 72" high
Storage Monolith

31

planning considerations

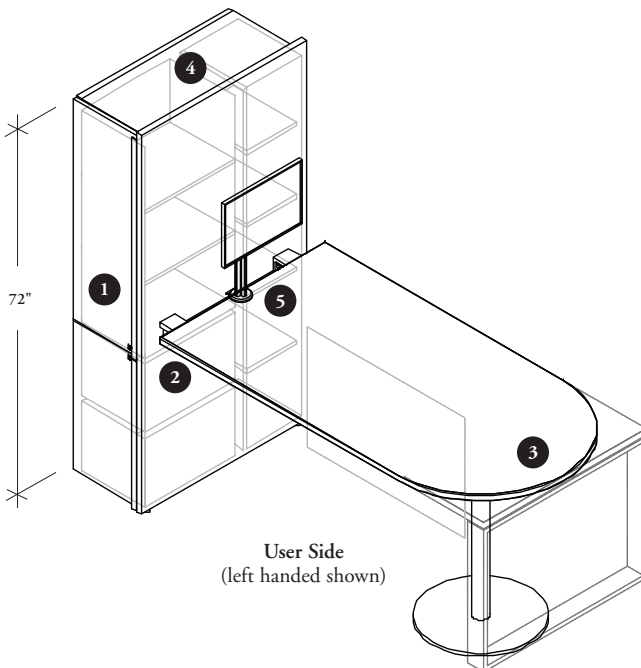

- 1 When optional hinged doors are specified the location of the door hinge corresponds to the handedness of the unit. Locks are optional. Available in 36" depth and 51" and 72" heights
- 2 The user side is determined by the location of power which always points to the user
- 3 The rectangular worksurface is only available with the rectangular leg and the bullet worksurface with the post leg
- 4 Ambient Light (SWLED), Modesty Panel (SWMP_), Pull-Out CPU Shelf (SWPS), and Accessory Rail Elements (SWDA) may be ordered separately. Ambient Light (SWLED) is not recommended for use on 51" high storage monolith. For more information, please see the *Accessory Basics* page in this section
- 5 The MAST Arm is an accessory that can be ordered separately to support media based work and collaboration, and is available from Complements: *Teknion's Ergonomics & Accessories* Program Catalog. When using the MAST Arm with Sidewise it must be mounted above the Technology Bridge, in front of the storage monolith so the user and the guest are able to view the monitor in a collaborative setting. In this application, use MAST Manual Arm (YMSTM) with a Marketplace Edge Clamp mount option

planning with consultation hub (continued)

storage options for desk height, 51" high

36" deep x 51" high x 16" long (left hand version with optional door heights shown)

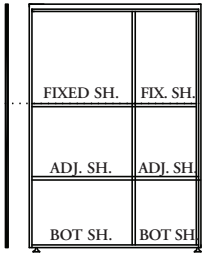

Shelf (B)

storage options for desk height, 72" high

36" deep x 72" high x 16" long (left hand version with optional door heights shown)

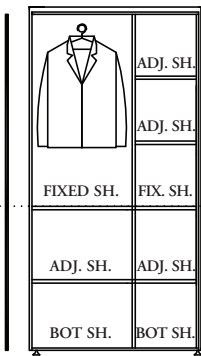

Coat/Shelf (A)

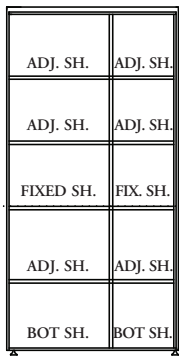

Shelf (B)

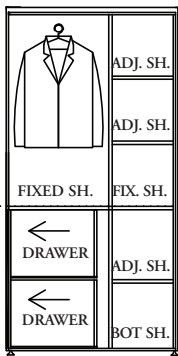

Coat/Drawer (C)

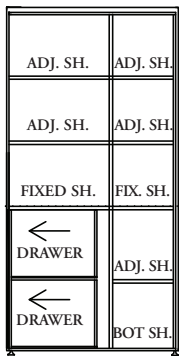

Shelf/Drawer (D)

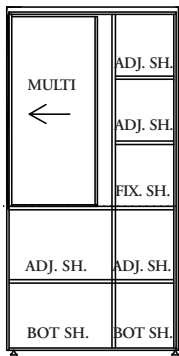

Multi-Drawer/
Shelf (E)

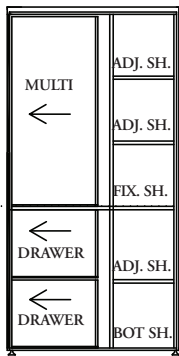

Multi-Drawer/
Drawers (F)
(available with door
option only)

storage options for counter height, 72" high

Storage options Coat/Drawer (C) and Shelf/Drawer (D) are not available in counter height configurations. Open shelves are always provided on the guest side. Adjustable shelves have 2" height range.

36" deep x 72" high x 16" long (left hand version with optional door heights shown)

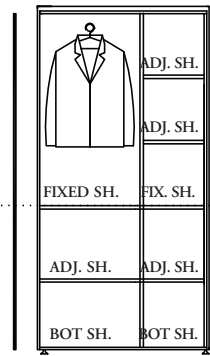

Coat/Shelf (A)

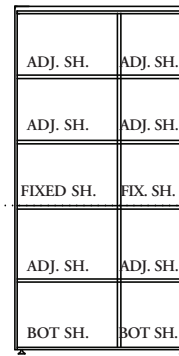

Shelf (B)

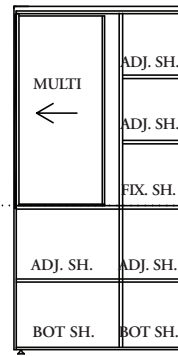

Multi-Drawer/
Shelf (E)

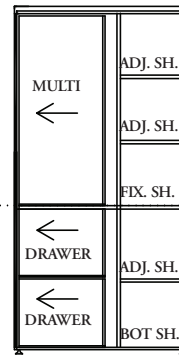

Multi-Drawer/
Drawers (F)
(available with door
option only)

The Meeting Hub is ideal for small offices or enclaves and for small team meetings with little storage requirements.

Meeting Hub, 51" High, Lounge Height (SWLM), 72" High, Desk Height (SWDM), 72" High, Counter Height (SWCM)

- Consist of a storage monolith, worksurface, post leg option and a Technology Bridge
- Accommodates three users
- Worksurface is round, 48" in diameter and is supported with a post leg
- Available in 24", 29" and 36" work heights. At 24" work height, the storage monolith is 51" high
- Can support a television/monitor up to 32" wide mounted with customers' own monitor mount
- Front monitor grommet option is available, 2" x 6" rectangular opening, 5" above the worksurface
- Configurations available in 72" high storage monolith: Coat/Shelf (A)
- Configurations available in 51" high storage monolith: Shelves (B), with open shelves on guest side
- Doors are available as an option on all configurations
- The storage monolith is not freestanding so cannot be used with other desks

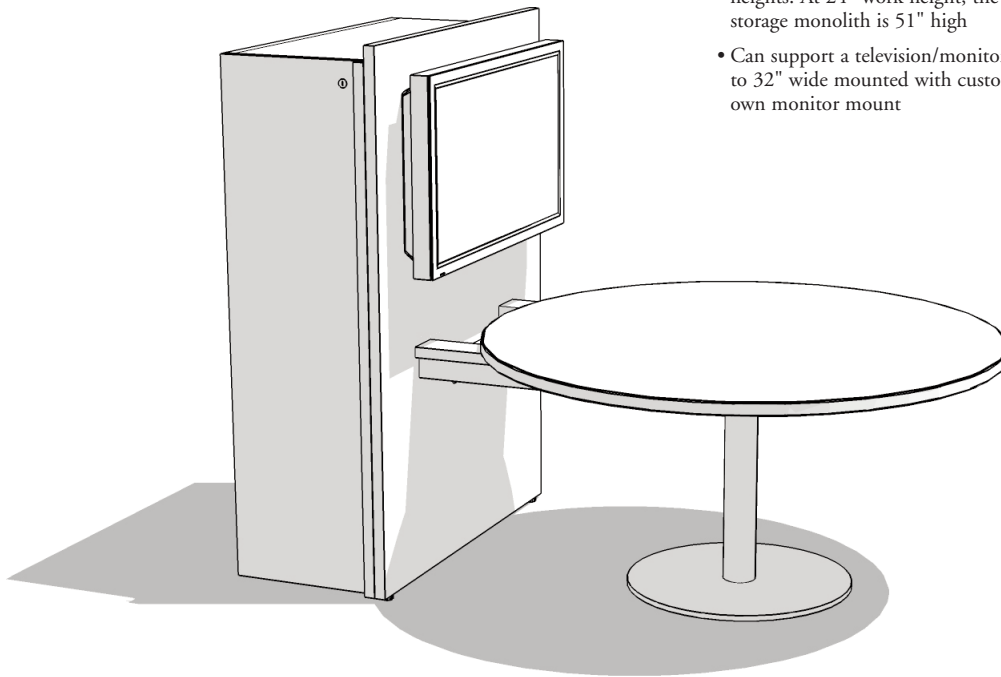

Finishes

Standard wire management grommet and optional monitor wire management grommets are finished in Platinum Grey. Please see *Finishes Guide* page in this section for Meeting Hub finishes

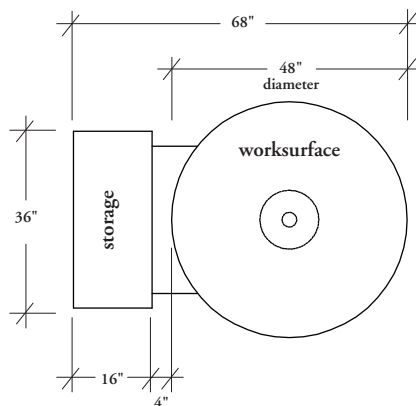

planning with meeting hub

The following should be taken into consideration when planning with the Meeting Hub.

height options

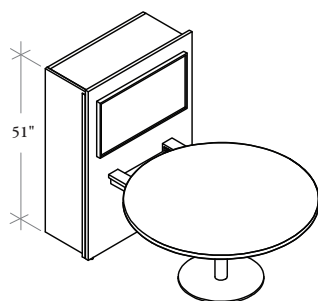

24" Lounge Height
with 51" high
Storage Monolith

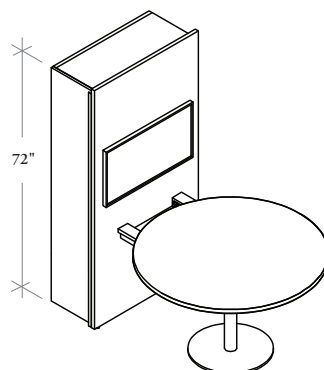

29" Desk Height
with 72" high
Storage Monolith

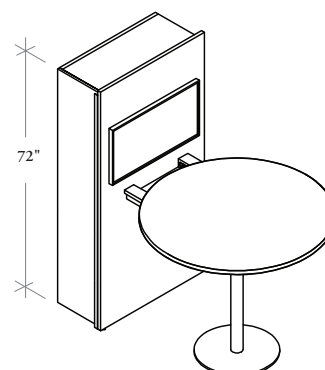

36" Counter Height
with 72" high
Storage Monolith

planning considerations

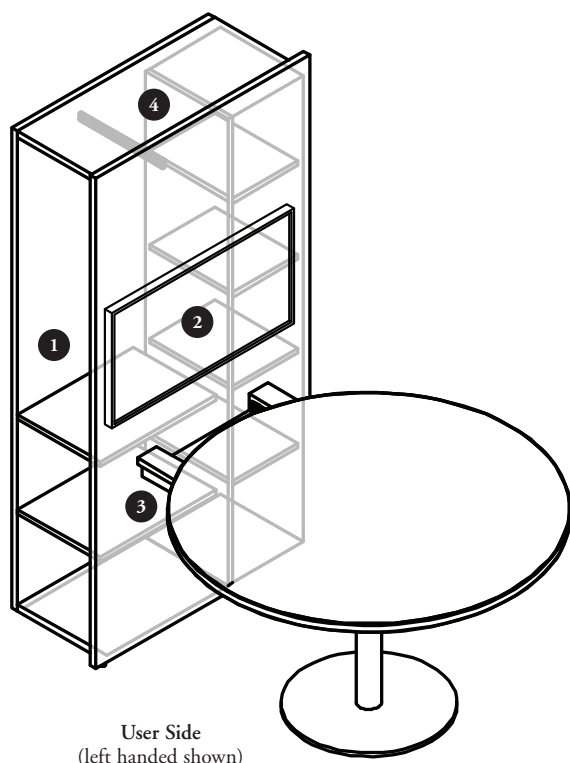

User Side
(left handed shown)

- 1 When optional hinged doors are specified the location of the door hinge corresponds to the handedness of the unit. Locks are optional. Available in 48" diameter worksurface and 72" height
- 2 The customer must supply their own monitor and mounting brackets if mounting one to the storage monolith
- 3 The user side is determined by the location of power which always points to the user
- 4 Ambient Light (SWLED) and Pull-Out CPU Shelf (SWPS) may be specified separately. Ambient Light (SWLED) is not recommended for use on 51" high storage monolith

planning with meeting hub (continued)

monitor mounting

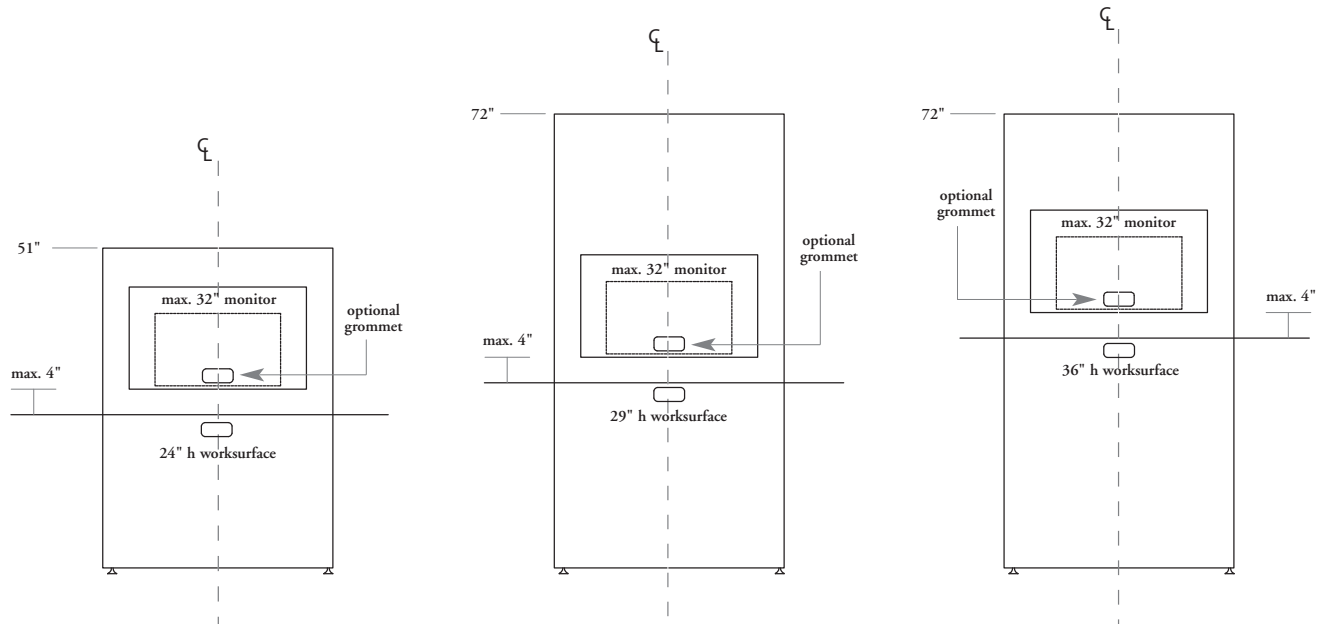

- Monitor mount must be attached to storage monolith using bolt and nut connections through the storage monolith front wall. Face-mounted wood screw connections are not recommended
- When choosing to mount a monitor on the storage monolith, the maximum size that the monitor can be is 32" wide
- The grommet option for monitor wire management is 2" high x 6" wide and located 5" above the workspace
- When installing the monitor, it should be no more than 4" above the workspace in order to cover the grommet hole and wires

storage options for 51" lounge height, 72" desk height and 72" counter height

(left hand version with optional door heights shown)

Open shelves are always provided on the guest side. Adjustable shelves have a 2" high adjustment range.

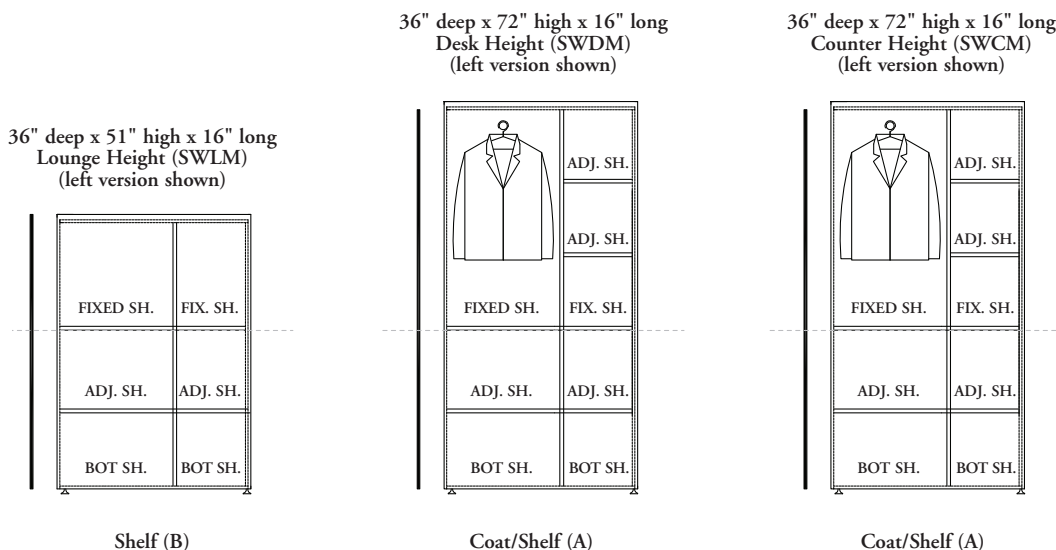

accessories & storage basics

Sidewise offers a variety of accessories which add flexibility and personalize each users space.

36

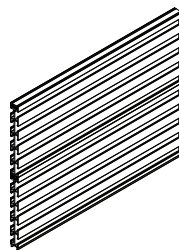
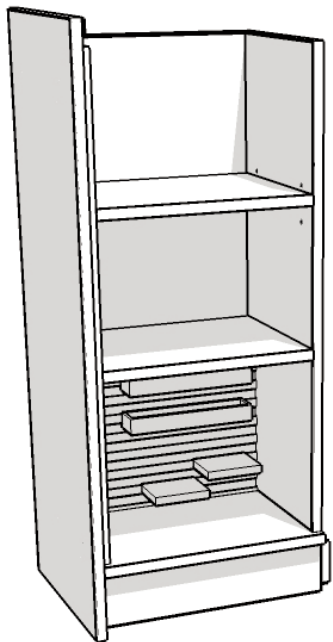

Accessory Rail Elements (SWDA)

- Can be used in a storage monolith that has the Multi-Drawer as an option
- The Multi-Drawer includes one fixed shelf and one adjustable shelf and the Accessory Rail Element is secured under the fixed shelf, at the bottom of the drawer. An additional element can be mounted above the fixed shelf when the height adjustable shelf is removed

- The Accessory Rail Element (SWDA) accommodates the fx Tray Set (YFXT), fx Personal Box (YFXP), fx Letter Tray (YFXL) and fx Binder Bins (YFXB) as well as Personal Organizers (PAX) which are all available from Complements: *Teknion's Ergonomics & Accessories Program*
- fx Letter Trays (YFXT) and Binder Bins (YFXB) can also be used freestanding on shelves or worksurfaces

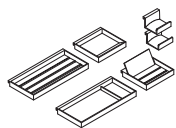

fx Tray Set
(YFXT)

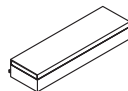

fx Personal Box
(YFXP)

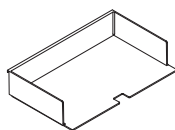

fx Letter Tray
(YFXL)

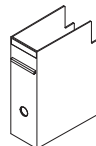

fx Binder Bin
(YFXB)



Personal Organizers (PAX)

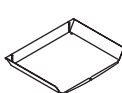

basic

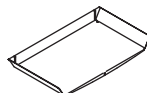

with legal sized folders

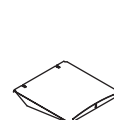

with 2 fx letter tray

Storage monolith configurations that have drawers can accommodate two fx Letter Trays (YFXL). Drawers come integrated with file rails that also allow for Legal-sized hanging folders.

accessories & storage basics (continued)

LED Ambient Light (SWLED)

- Provides uplighting on 72" high storage monoliths
- Available in 2 lengths, 12" and 24". 12" lights should be specified for the Lounge Recliner application and the 24" lengths for Solo Desk, Consultation Hub and Meeting Hub applications
- All configurations except for 51" high storage monoliths (SWER, SWEB, SWLM) have built-in internal grommets to accommodate LED Ambient Light wiring, lights can be added on site at a later date. A Casual Wire Manager Kit is included with LED Ambient Light, available in Grey. An Occupancy Sensor is included with all LED Ambient Lights

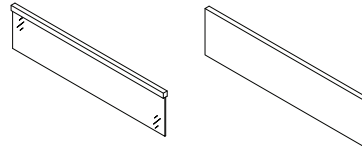
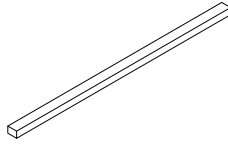
**Modesty Panel (SWMPG/SWMPs)**

- Can be used on the Consultation Hub and must be specified to match the corresponding leg style
- Available for all 78", 84" & 90" overall width Consultation Hub configurations
- Should be installed centered on the worksurface
- Available on Consultation Hub configurations and are recommended for Desk Height configurations
- Available in two styles, Solid and Glass

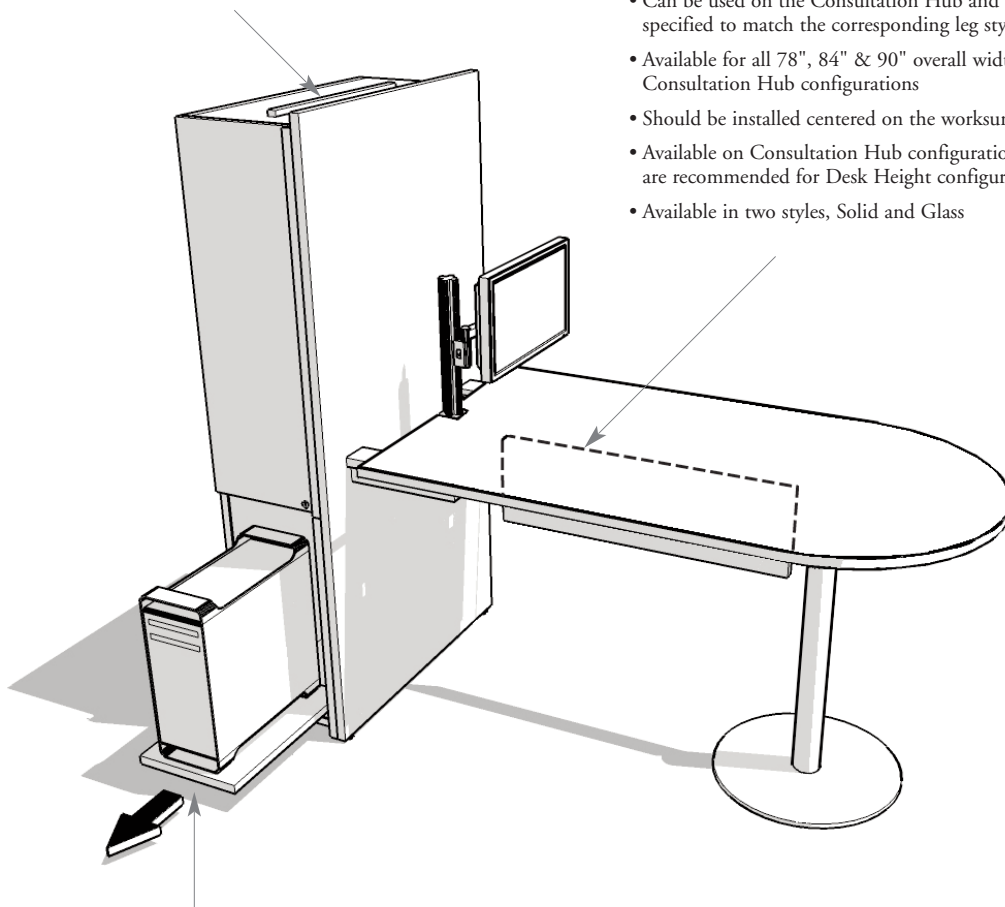
**Pull-Out CPU Shelf (SWPS)**

- It can be used for internal configurations with bottom shelf storage
- The adjustable shelf is removed and the Pull-Out CPU Shelf is mounted to the bottom shelf
- Is complete with mounting hardware and glides

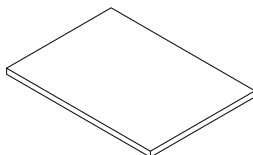
**Finishes**

Modesty Panel is available in Laminate, Flintwood, Natural Veneer for the solid panel or frosted glass. The finish should always match the worksurface except when glass is used. Please see *Finishes Guide* page in this section for Pull-Out CPU Shelf finishes.

planning with accessories & storage

ambient light and occupancy sensor planning considerations

38

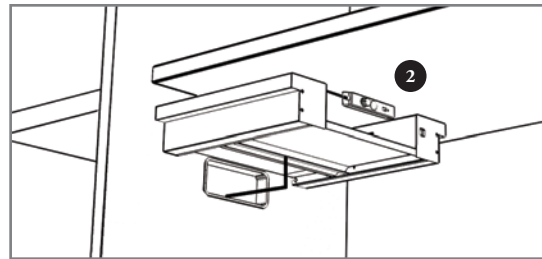
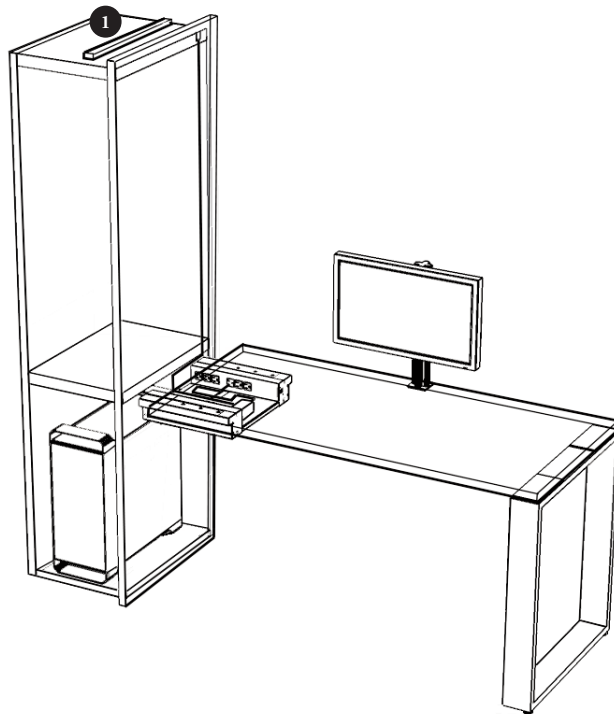

- 1 LED Ambient Light with Occupancy Sensor is not recommended for use on 51" high storage monoliths
- 2 When Occupancy Sensor is switched on, a blue LED light indicator stays on until the sensor detects no occupancy and will turn off after 20 minutes. It provides an opportunity for LEED credits and appeals to smart, energy conservation sensitive projects
Occupancy Sensor can be secured to the Technology Bridge by a magnet or to the work surface with mounting hardware and bracket (included) under the work surface
- 3 For the Lounge Recliner, the Occupancy Sensor is mounted to the interior side of the open storage next to the Power Bar under the bench

modesty panel planning considerations

Double-Sided Consultation

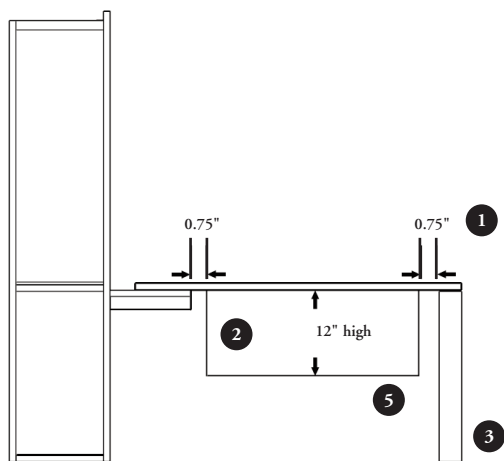

Rectangular Worksurface with Rectangular Leg

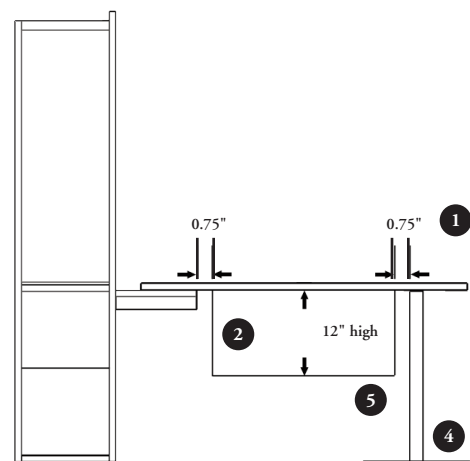

Rectangular Worksurface with Post Leg

- 1 There is a 0.75" gap between the support and Modesty Panel on one edge and between the support and Technology Bridge on the opposite end
- 2 The length of the Modesty Panel will differ depending on what type of work surface it is under
- 3 The rectangular work surface is supported by a rectangular leg installed at the edge of the work surface, which maximizes the amount of space available to allow for a Modesty Panel
- 4 The bullet work surface is supported by a post leg which is inset from the edge of the work surface leaving a smaller space available for a Modesty Panel
- 5 Is to be installed centered under the work surface with a 0.75" space on either side to allow for mounting hardware and wire management

The following should be considered when planning with locks.

Storage monoliths are available with locks keyed alike or keyed randomly for a dedicated lock. In configurations that have two drawers, one lock is provided on the top drawer, this locks both top and bottom drawers.

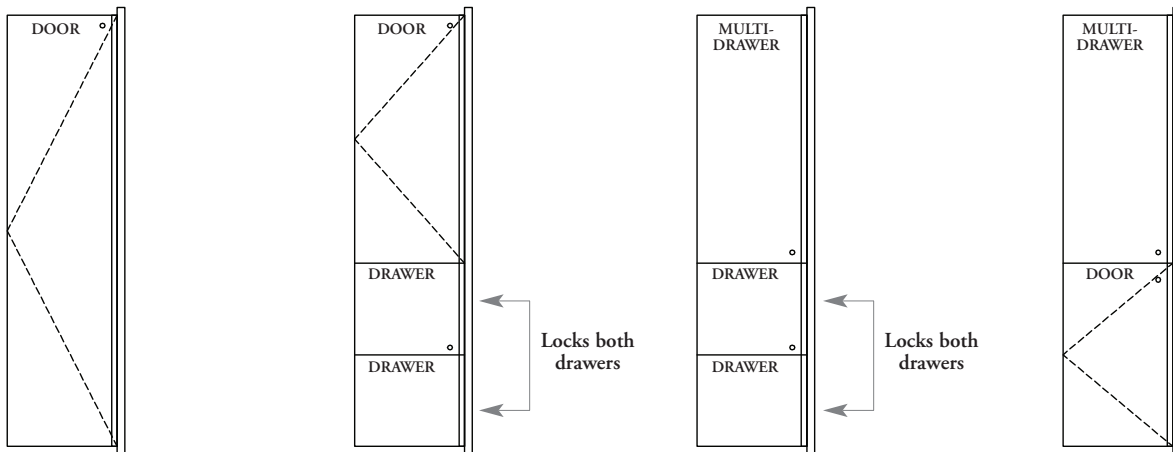

- Locks are available as Key Alike, Key Randomly, No Key
- Locks are finished in Brushed Chrome
- Left hand version shown. Right handed is mirror image

For further details on how to specify locks, please see the Teknion Lock Specification Guide on our website.

The following outlines the finish options available for Sidewise.

finishes

- When selecting Sidewise finishes, the worksurface will determine the options for the Case and Door/Drawer finishes. The Case will default to the worksurface finish
- The Case finish will be applied to the Shelf and Coat formats
- The door/drawer finish will be applied to the door option as well as the exterior and interior of the drawers and multi-drawer format
- When a Laminate worksurface is specified, the worksurface Edge Trim must also be specified. When Flintwood or Natural Veneer are specified, Edge Trim defaults to the worksurface finish

40

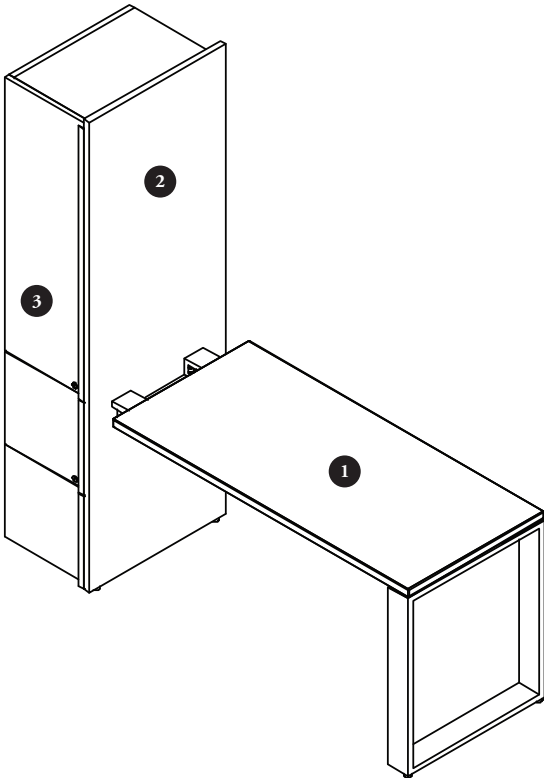

1	2	3
Worksurface Finish	Case Finish	Door/Drawer Finish
Foundation Laminate	Source Laminate	Source Laminate
Flintwood	Flintwood	Seamless Color Flintwood
Veneer	Veneer	Seamless Color Veneer

Item	Finish
Technology Bridge	Clear Anodized with Platinum details
Rectangular Leg	Clear Anodized
Post Leg	Painted (Platinum) Polished (Brushed Nickel Plated)
Handles	Clear Anodized
Grommets	Platinum Grey
fx Accessory Rail	Clear Anodized
Locks	Brushed Chrome
Leveller	Chrome
Cushions & Bolsters	Fabric and Leather

finishes guide (continued)

The following outlines the wood grain direction on Sidewise.

grain direction

- When planning with finishes it is important to note the grain direction for each finish, particularly on the doors and drawers of the storage monolith when either Flintwood or Veneer is chosen
- Storage monolith grain direction is consistent between workstation and recliner styles
- Laminate grains do not match across fronts on doors and multi-drawers

4I

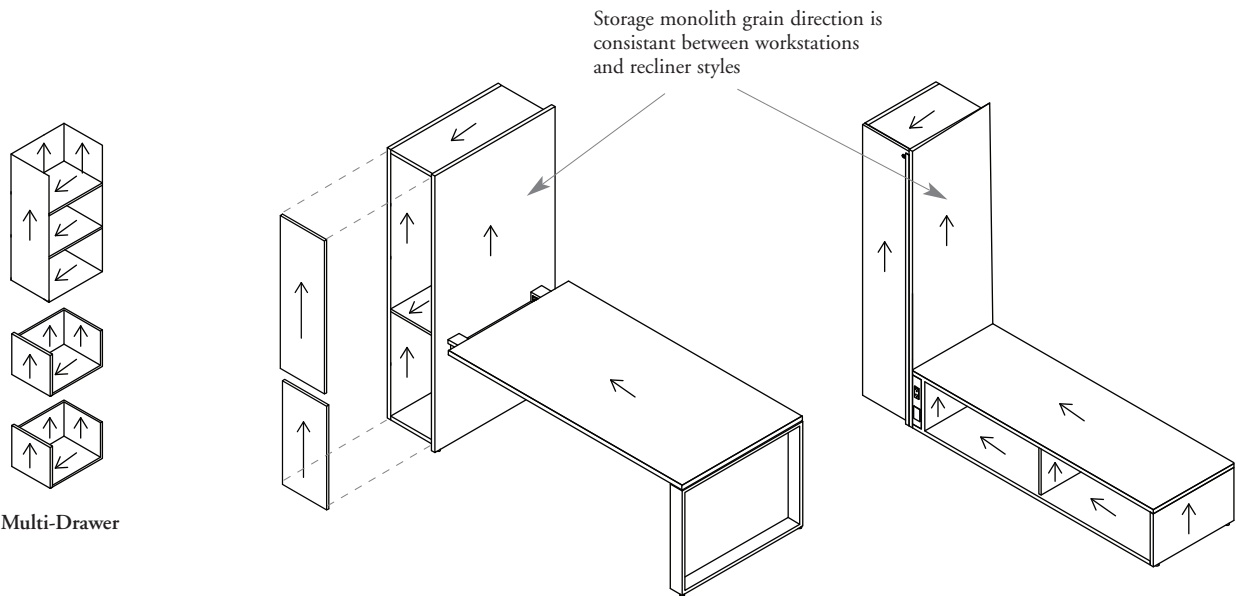

Multi-Drawer

Multi-Drawer

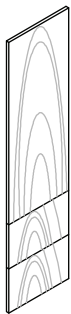

Laminate Grains do not match across fronts

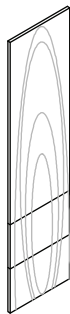

Flintwood and Natural Veneer Grains match across fronts

Door



Laminate Grains do not match across fronts



Flintwood and Natural Veneer Grains match across fronts

solo